



GM.90



GM.90



VTIČNA TIPALA / THERMOCOUPLE

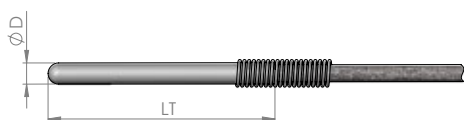

Koda / Code:	GM.945050	GM.9450100	GM.946050	GM.9460100	GM.956050	GM.9560100
Dimenzija / Dimension:	Ø 5x50 mm	Ø 5x100 mm	Ø 6x50 mm	Ø 6x100 mm	Ø 6x50 mm	Ø 6x100 mm
Dolžina kabla / Cable length:	2000 mm	2000 mm	2000 mm	2000 mm	2000 mm	2000 mm
Material:	AISI304	AISI304	AISI304	AISI304	AISI304	AISI304
Tip tipala / Sensor type:	FeCuNi/J	FeCuNi/J	FeCuNi/J	FeCuNi/J	PT-100	PT-100
Max temp.:	400°C	400°C	400°C	400°C	300°C	300°C

BAJONETNA TIPALA / BAYONET THERMOCOUPLE

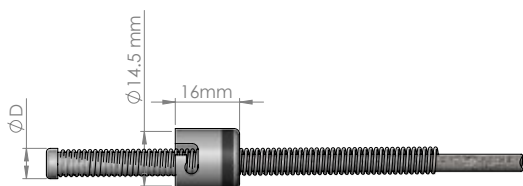

Koda / Code:	GM.94160	GM.94180
Dimenzija / Dimension:	Ø 6 mm	Ø 8 mm
Dolžina kabla / Cable length:	2000 mm	2000 mm
Material:	AISI304	AISI304
Tip tipala / Sensor type:	FeCuNi/J	FeCuNi/J
Max temp.:	400°C	400°C

NASTAVEK ZA BAJONET / BAYONET ADAPTOR

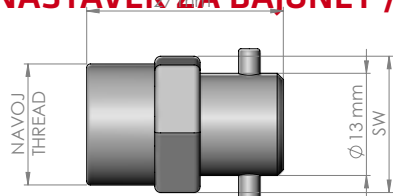

Koda	Ključ	Navoj
9414	SW17	R1/4"
9438	SW17	R3/8"
9412	SW17	M12x1
Code	Wrench	Thread

OBJEMNO TIPALO_AXIAL / CLAMP THERMOCOUPLE_AXIAL

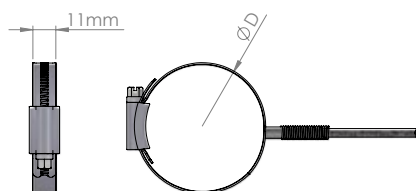

Koda / Code:	GM.9725	GM.9740	GM.9770
Dimenzija / Dimension:	Ø25-Ø40	Ø40-Ø60	Ø70-Ø90
Dolžina kabl / Cable length:	2000 mm	2000 mm	2000 mm
Material:	AISI304	AISI304	AISI304
Tip tipala / Sensor type:	FeCuNi/J	FeCuNi/J	FeCuNi/J
Max temp.:	400°C	400°C	400°C

OBJEMOTIPALO_TANG / CLAMP THERMOCOUPLE_TANG



Koda / Code:	GM.9725	GM.9740	GM.9770
Dimenzija / Dimension:	Ø25-Ø40	Ø40-Ø60	Ø70-Ø90
Dolžina kabl / Cable length	2000 mm	2000 mm	2000 mm
Material:	AISI304	AISI304	AISI304
Tip tipala / Sensor type:	FeCuNi/J	FeCuNi/J	FeCuNi/J
Max temp.:	400°C	400°C	400°C

PODTIPALO / UNDER NOZZLE THERMOCOUPLE

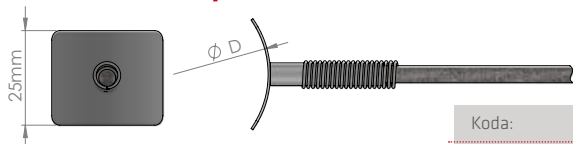

Koda: Code:	GM.9430	GM.9450	GM.9470
Dimenzija / Dimension:	Ø30-Ø50	Ø50-Ø70	Ø70-Ø100
Dolžina kabl / Cable length	2000 mm	2000 mm	2000 mm
Material:	AISI304	AISI304	AISI304
Tip tipala / Sensor type:	FeCuNi/J	FeCuNi/J	FeCuNi/J
Max temp.:	400°C	400°C	400°C

TIPALO ZA TOPLE ŠOBE / NOZZLE THERMOCOUPLE

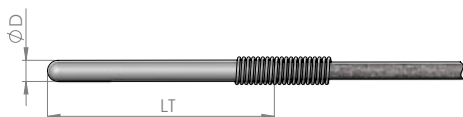

Koda / Code:	GM.941050	GM.9410100	GM.9410150	GM.9410200	GM.941550	GM.9415100	GM.9415150	GM.9415200
Dimenzija / Dimension:	Ø1,5x50mm	Ø1,5x100mm	Ø1,5x150mm	Ø1,5x200mm	Ø1,0x50mm	Ø1,0x100mm	Ø1,0x150mm	Ø1,0x200mm
Dolžina kabl / Cable length	2000 mm	2000 mm	2000 mm	2000 mm	2000 mm	2000 mm	2000 mm	2000 mm
Material:	AISI304	AISI304	AISI304	AISI304	AISI304	AISI304	AISI304	AISI304
Tip tipala / Sensor type:	FeCuNi/J	FeCuNi/J	FeCuNi/J	FeCuNi/J	FeCuNi/J	FeCuNi/J	FeCuNi/J	FeCuNi/J
Max temp.:	650°C	650°C	650°C	650°C	650°C	650°C	650°C	650°C

TIPALO ZA BLOK / MANIFOLD THERMOCOUPLE

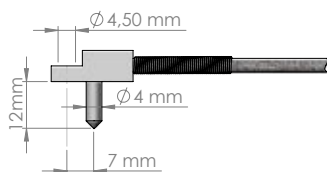

Koda / Code:	GM.9404012
Dimenzija / Dimension:	Ø4x12 mm
Dolžina kabl / Cable length	2000 mm
Material:	Brass
Tip tipala / Sensor type:	FeCuNi/J
Max temp.:	400°C

VIJAČNO TIPALO / SCREW-IN THERMOCOUPLE

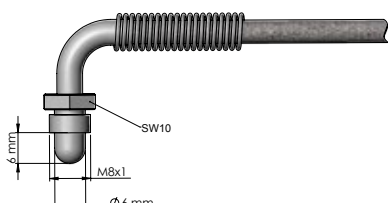

Koda / Code:	GM.9404012
Dimenzija / Dimension:	M8x1/Ø6mm
Dolžina kabl / Cable length	2000 mm
Material:	AISI304
Tip tipala / Sensor type:	FeCuNi/J
Max temp.:	400°C



GRELCI MARAS d.o.o.

Jevčeva pot 2

1351 Brezovica pri Ljubljani

Slovenija / Slovenia

T: +386 1 365 3 518

F: +386 1 365 73 72

E: info@grelci-maras.si

www.grelci-maras.si